

Verso R 5000 H C5

Nominal air flow according to ErP 2018, m ³ /h	5355
Nominal air flow according to ErP 2018, l/s	1488
Supply voltage HW, V	3~400
Maximal operating current HW, A	13,1
Power supply cable W, mm ²	5x2,5
Electric power input of the fan drive at maximum flow rate, W	1000
Noise power level, L _{WA} , dB(A)	63
Noise pressure level, L _{PA} , dB(A), (3 m)	50
Filters dimensions BxHxL, mm	592x592-8x500
Unit dimensions BxHxL, mm	1300x1300x1872
Panel thickness, mm	50
Maintenance space, mm	1200
Unit weight, kg	442

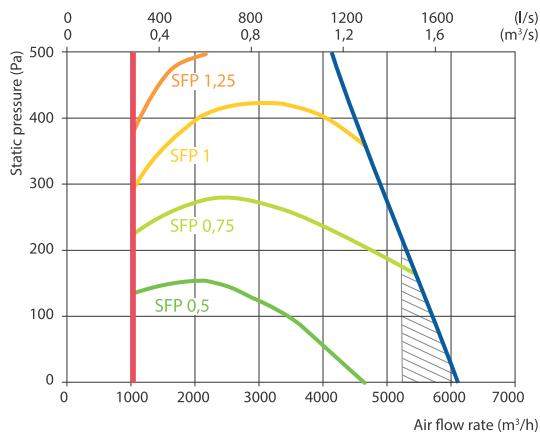

Performance



Does not conform to ErP2018 requirements

Accessories

Closing damper	SRU-M-1000x500+LF24/LM24
Silencer	ODA/EHA STS-IVR3BA-1000-500-700-S SUP/ETA STS-IVR3BA-1000-500-1250-S
PPU	PPU-HW-3R-20-4,0-W2
Water cooler	DCW-4,5-30
2-way valve	VVP45.25-10.0+SSC161.05HF
DX cooler	DCF-4,5-31-2
Cooling unit	2xMOU-55HFN8+KA8243

Temperature efficiency

	Winter					Summer		
Outside temperature, °C	-23	-15	-10	-5	0	25	30	35
After heat exchanger, °C	10,5	12,6	13,8	15,1	16,4	22,8	24,0	25,3
Indoor +22 °C, 20 % RH								

Hot water air heater

	Winter		
Water temperature in/out, °C	80/60	70/50	60/40
Capacity, kW	20,8	20,8	20,8
Flow rate, dm ³ /h	913	909	905
Pressure drop, kPa	3,8	3,8	3,8
Temperature in/out, °C	10,5 / 22,0	10,5 / 22,0	10,5 / 22,0
Maximal capacity, kW	38,9	30,5	21,4
Connection, "	1/2		

Shown as right (R1)

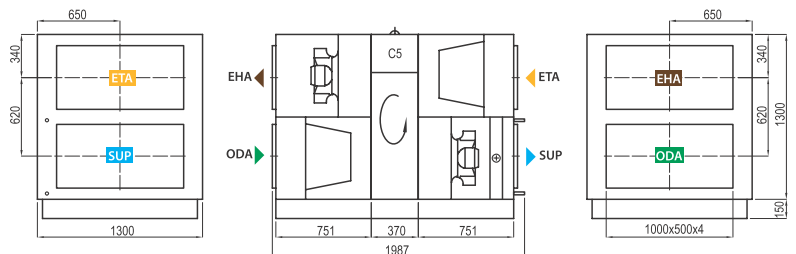

Shown as left (L1)



Shown as left (L2)



Shown as right (R2)



ODA – outdoor intake
 SUP – supply air
 ETA – extract indoor
 EHA – exhaust air